

Ersatzteilliste Doppelmembranpumpen

Spare part list Double diaphragm pump

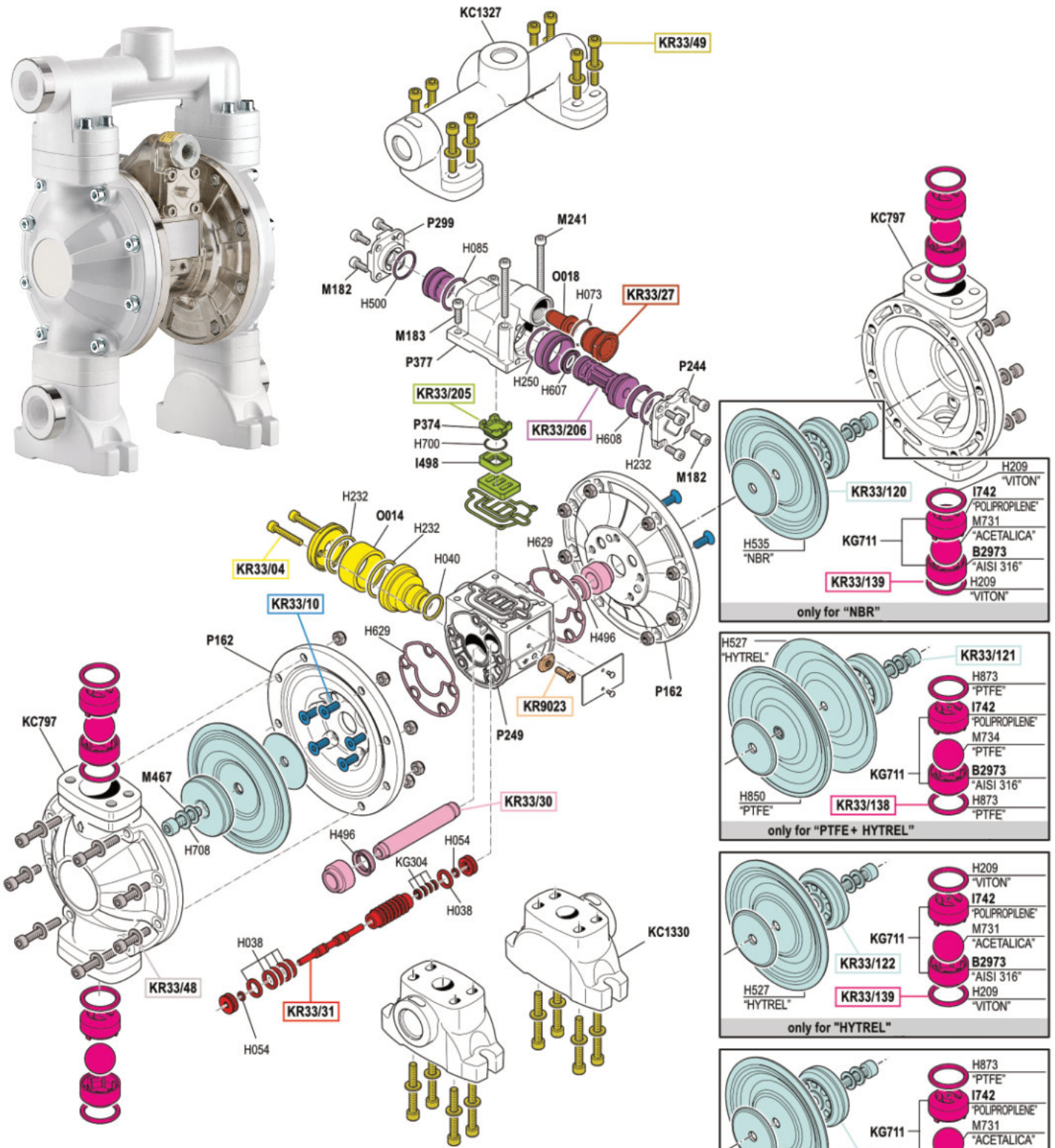

Pumpengehäuse / pump casing	Polypropylen
Membran / membranes	
EPDM	7.200.100
Hytrel	7.200.110
NBR	7.200.120
Santoprene	7.200.130
PTFE + Hytrel	7.200.140

only for "NBR"

- H209 "VITON"
- I742 "POLYPROPYLEN"
- M731 "ACETALICA"
- B2973 "AISI 316"
- H209 "VITON"

only for "PTFE + HYTREL"

- H873 "PTFE"
- I742 "POLYPROPYLEN"
- M734 "PTFE"
- B2973 "AISI 316"
- H873 "PTFE"

only for "HYTREL"

- H209 "VITON"
- I742 "POLYPROPYLEN"
- M731 "ACETALICA"
- B2973 "AISI 316"
- H209 "VITON"

only for "EPDM"

- H873 "PTFE"
- I742 "POLYPROPYLEN"
- M731 "ACETALICA"
- B2973 "AISI 316"
- H873 "PTFE"

only for "SANTOPRENE"

- H873 "PTFE"
- I742 "POLYPROPYLEN"
- M760 "SANTOPRENE"
- B2973 "AISI 316"
- H873 "PTFE"

Ersatzteilliste Doppelmembranpumpen

Spare part list Double diaphragm pump

Ersatzteile, Set Spare parts, set	Art.Nr. Item-No	Menge Qty	Art.Nr. Item-No	Menge Qty
KR33/120 (NBR)	H700	1	KR33/209 (air distributor gaskets kit)	1
KR33/121 (PTFE+Hytrel)	H708	2	KR33/210 (motor gaskets kit)	1
KR33/122 (Hytrel)	KC1327	1	KR33/286 (diaphragm + valve kit NBR)	1
KR33/123 (EPDM)	KC1330	2	KR33/287 (diaphragm + valve kit PTFE+Hytrel)	1
KR33/124 (Santoprene)	KC797	2	KR33/288 (diaphragm + valve kit Hytrel)	1
KR33/138 (PTFE+Hytrel)	M182	8	KR33/289 (diaphragm + valve kit EPDM)	1
KR33/139 (Hytrel/NBR)	M183	2	KR33/290 (diaphragm + valve kit Santoprene)	1
KR33/140 (EPDM)	M241	2		
KR33/141(Santoprene)	M467	2		
KR33/04	0014	1		
KR33/10	0018	1		
KR33/27	P162	2	Art.Nr. Item-No	Menge Qty
KR33/30	P244	1	KS33/150 (NBR) includes KR33/209, KR33/120, KR33/286	1
KR33/31	P249	1	KS33/151 (PTFE+Hytrel) includes KR33/209, KR33/120, KR33/287	1
KR33/48	P299	1	KS33/152 (Hytrel) includes KR33/209, KR33/120, KR33/288	1
KR33/49	P374	1	KS33/153 (EPDM) includes KR33/209, KR33/120, KR33/289	1
KR33/205	P377	1	KS33/154 Santoprene) includes KR33/209, KR33/120, KR33/290	1
KR33/206		1		
KR9023		1		
	H527 (Hytrel)	2		
	H535 (NBR)	2		
	H557 (EPDM)	2		
	H617 (Santoprene)	2		
	H850 (PTFE)	2		
	H209 (Viton)	8		
	H873 (PTFE)	8		
	KG711	4		
	M731 (Acetalica)	4		
	M734 (PTFE)	4		
	M760 (Santoprene)	4		

